



# ALUMINUM ELECTROLYTIC CAPACITOR

093 PMG-SI



## High Voltage Snap-In Type

### KEY BENEFITS

- Temperature range: - 25 °C to + 85 °C
- Useful life at 85 °C and  $I_R$  applied: 2000 hours
- Case sizes: 22 mm x 25 mm to 35 mm x 50 mm
- Capacitance rating: 68  $\mu$ F to 2200  $\mu$ F (tolerance  $\pm$  20 %)
- Voltage ratings: 200 V to 450 V

### APPLICATIONS

- Digital TV receiver power supply
- Consumer welding equipment
- Uninterruptible power supply (UPS)
- Air-conditioning motor control
- Washing machine motor control
- Refrigerator compressor motor control

Datasheet is available on our web site at [www.vishay.com](http://www.vishay.com)  
for 093 PMG-SI - <http://www.vishay.com/doc?28383>

# Aluminum Capacitors

## Power Miniaturized General Purpose Snap-In

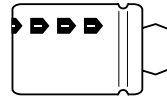
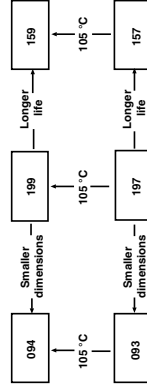

Fig. 1 Component outlines



### FEATURES

- Polarized aluminum electrolytic capacitors, non-solid electrolyte
- Large types, miniaturized dimensions, cylindrical aluminum case insulated with a blue sleeve
- Useful life: 2000 hours at 85 °C



### APPLICATIONS

- Consumer electronics
- Whitegood motor control
- Electronic drives
- Smtps/ups

### MARKING

The capacitors are marked (where possible) with the following information:

- Rated capacitance (in  $\mu\text{F}$ )
- Tolerance on rated capacitance, code letter in accordance with IEC 60062 (M for  $\pm 20\%$ )
- Rated voltage (in V)
- Date code
- Name of manufacturer
- '-' sign to identify the negative terminal, visible from the top and side of the capacitor
- Code number (last 8 digits)
- Maximum operating temperature

DESCRIPTION	VALUE
Normal case size (Ø D x L in mm)	22 x 25 to 35 x 50
Rated capacitance range, C <sub>r</sub>	68 $\mu\text{F}$ to 2200 $\mu\text{F}$
Tolerance on C <sub>r</sub>	$\pm 20\%$
Rated voltage range, U <sub>r</sub>	200 V to 450 V
Category temperature range	-25 to +85 °C
Useful life at 85 °C	2000 hours
Useful life at 40 °C and 1.4 x I <sub>r</sub> applied	36 000 hours
Shelf life at 0 V, 85 °C	500 hours
Based on sectional specification	IEC 60 384-4/EN130300/W of JIS C5141

C <sub>r</sub> (μF)	U <sub>r</sub> (V)		Ø D x L (in mm)
	400	420	
68	200	22 x 25	450
82		22 x 25	22 x 25
100		22 x 25	22 x 30
120		22 x 25	22 x 30
150		22 x 30	22 x 25
		25 x 25	22 x 35
180		22 x 35	22 x 40
		25 x 30	25 x 30
		25 x 30	30 x 25
220		22 x 40	22 x 50
		25 x 30	25 x 35
		30 x 25	30 x 25
		22 x 50	30 x 30
270		22 x 30	35 x 25

Revision 15-Apr-08

C <sub>r</sub> (μF)	U <sub>r</sub> (V)		Ø D x L (in mm)
	200	250	
330	250 <td>400 <td>420</td> </td>	400 <td>420</td>	420
	22 x 35	25 x 40	25 x 50
	22 x 35	30 x 30	30 x 35
390	22 x 30	25 x 25	35 x 30
	22 x 35	25 x 30	30 x 40
	25 x 30	35 x 30	35 x 35
470	22 x 35	25 x 35	35 x 35
	25 x 30	35 x 40	35 x 40
560	25 x 30	30 x 45	30 x 50
	25 x 35	35 x 35	35 x 40
680	25 x 30	35 x 40	35 x 45
820	25 x 40	35 x 50	35 x 50
1000	30 x 35	35 x 50	35 x 50
1200	30 x 40	35 x 40	35 x 40
1500	30 x 45	35 x 45	35 x 45
1800	30 x 50	35 x 50	35 x 50
2200	35 x 45		

### DIMENSIONS in millimeters AND AVAILABLE FORMS

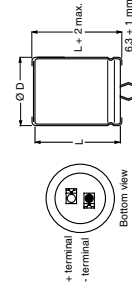

Fig. 2 Two terminal snap-in

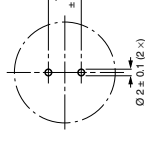

Fig. 3 Mounting hole diagram

Table 1

NOMINAL CASE SIZE Ø D x L	Ø D <sub>max.</sub>	L <sub>max.</sub>	MASS (g)	PACKAGING QUANTITIES	CARDBOARD BOX DIMENSIONS L x W x H
22 x 25	22.5	25.5	≈ 12	216	280 x 240 x 140
22 x 30	22.5	30.5	≈ 16	144	280 x 240 x 140
22 x 35	22.5	35.5	≈ 20	144	280 x 240 x 105
22 x 40	22.5	40.5	≈ 23	144	280 x 240 x 105
22 x 45	22.5	45.5	≈ 26	144	280 x 240 x 140
22 x 50	22.5	50.5	≈ 29	72	280 x 240 x 105
25 x 30	25.5	32.0	≈ 20	216	280 x 240 x 140
25 x 35	25.5	35.5	≈ 24	144	280 x 240 x 105
25 x 40	25.5	40.5	≈ 27	144	280 x 240 x 105
25 x 45	25.5	45.5	≈ 32	144	280 x 240 x 140
25 x 50	25.5	50.5	≈ 36	72	280 x 240 x 105
30 x 30	30.5	32.5	≈ 25	168	280 x 240 x 140
30 x 35	30.5	35.5	≈ 30	168	280 x 240 x 140
30 x 40	30.5	37.5	≈ 35	112	280 x 240 x 105
30 x 45	30.5	41.5	≈ 40	112	280 x 240 x 105
30 x 50	30.5	45.5	≈ 45	56	280 x 240 x 140
35 x 25	35.5	51.5	≈ 50	112	280 x 240 x 140
35 x 30	35.5	55.5	≈ 55	112	280 x 240 x 140
35 x 35	35.5	59.5	≈ 60	56	280 x 240 x 105
35 x 40	35.5	63.5	≈ 65	56	280 x 240 x 105
35 x 45	35.5	67.5	≈ 70	56	280 x 240 x 140
35 x 50	35.5	71.5	≈ 75	56	280 x 240 x 140

**NOTICE** Specifications of the products displayed herein are subject to change without notice. Vishay Intertechnology, Inc. or anyone on its behalf, assumes no responsibility or liability for any errors or inaccuracies. Information contained herein is intended to provide a product description only. No license, express or implied, by estoppel or otherwise, to any intellectual property rights is granted by this document. Except as provided in Vishay's terms and conditions of sale for such products, Vishay assumes no liability whatsoever and disclaims any express or implied warranty, relating to sale and/or use of Vishay products including liability or warranties relating to fitness for a particular purpose, merchantability, or infringement of any patent, copyright, or other intellectual property right. The products shown herein are not designed for use in medical, life-saving, or life-sustaining applications. Customers using or selling these products for use in such applications do so at their own risk and agree to fully indemnify Vishay for any damages resulting from such improper use or sale.